

CMSD6263  
 CMSD6263A  
 CMSD6263C  
 CMSD6263S

**SURFACE MOUNT SUPERmini™  
 SILICON SCHOTTKY DIODES**

**SUPERmini™**



**SOT-323 CASE**

# Central™ Semiconductor Corp.

## DESCRIPTION:

The CENTRAL SEMICONDUCTOR CMSD6263 Series types are High Voltage Silicon Schottky diodes, epoxy molded in a SUPERmini™ surface mount package, designed for low current fast switching applications requiring a low forward voltage drop.

The following configurations are available:

## MARKING CODE:

<b>CMSD6263</b>	SINGLE	<b>76D</b>
<b>CMSD6263A</b>	DUAL, COMMON ANODE	<b>98D</b>
<b>CMSD6263C</b>	DUAL, COMMON CATHODE	<b>97D</b>
<b>CMSD6263S</b>	DUAL, IN SERIES	<b>96D</b>

## MAXIMUM RATINGS: (T<sub>A</sub>=25°C)

	SYMBOL		UNITS
Peak Repetitive Reverse Voltage	V <sub>RRM</sub>	70	V
Continuous Forward Current	I <sub>F</sub>	15	mA
Forward Surge Current, tp=1.0 s	I <sub>FSM</sub>	50	mA
Power Dissipation	P <sub>D</sub>	275	mW
Operating and Storage			
Junction Temperature	T <sub>J</sub> , T <sub>stg</sub>	-65 to +150	°C
Thermal Resistance	θ <sub>JA</sub>	455	°C/W

## ELECTRICAL CHARACTERISTICS PER DIODE: (T<sub>A</sub>=25°C)

SYMBOL	TEST CONDITIONS	MIN	TYP	MAX	UNITS
BV <sub>R</sub>	I <sub>R</sub> =10μA	70			V
V <sub>F</sub>	I <sub>F</sub> =1.0mA		395	410	mV
I <sub>R</sub>	V <sub>R</sub> =50V		98	200	nA
C <sub>T</sub>	V <sub>R</sub> =0V, f=1.0MHz			2.0	pF
t <sub>rr</sub>	I <sub>R</sub> =I <sub>F</sub> =10mA, I <sub>rr</sub> =1mA, R <sub>L</sub> =100Ω			5.0	ns

**SURFACE MOUNT SUPERmini<sup>TM</sup>**  
**SILICON SCHOTTKY DIODES**

**SOT-323 CASE - MECHANICAL OUTLINE**

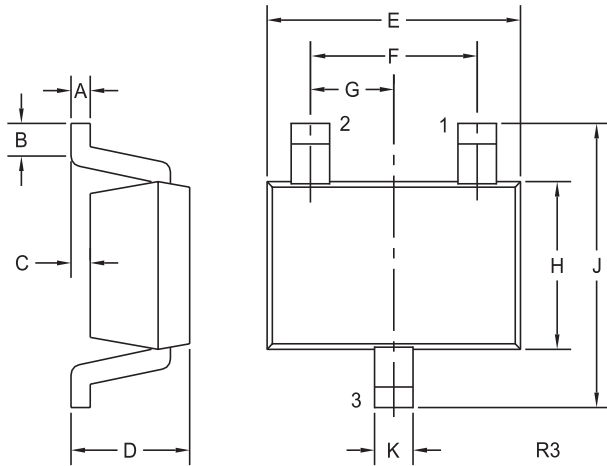

SYMBOL	DIMENSIONS			
	INCHES		MILLIMETERS	
	MIN	MAX	MIN	MAX
A	0.002	0.008	0.05	0.20
B	0.004	-	0.10	-
C	-	0.004	-	0.10
D	0.031	0.043	0.80	1.10
E	0.071	0.087	1.80	2.20
F	0.051		1.30	
G	0.026		0.65	
H	0.045	0.053	1.15	1.35
J	0.079	0.087	2.00	2.20
K	0.008	0.016	0.20	0.40

SOT-323 (REV: R3)

**PIN CONFIGURATIONS**

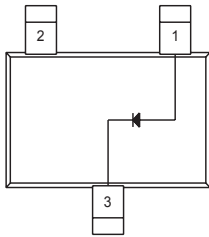

**CM5D6263**

- 1) Anode
- 2) No Connection
- 3) Cathode

**MARKING CODE:**  
**76D**

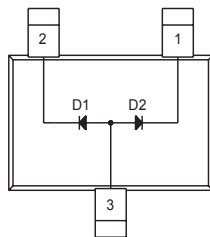

**CM5D6263A**

- 1) Cathode D2
- 2) Cathode D1
- 3) Anode D1, D2

**MARKING CODE:**  
**98D**

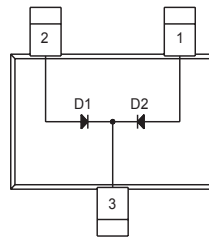

**CM5D6263C**

- 1) Anode D2
- 2) Anode D1
- 3) Cathode D1, D2

**MARKING CODE:**  
**97D**

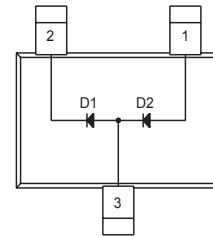

**CM5D6263S**

- 1) Anode D2
- 2) Cathode D1
- 3) Anode D1, Cathode D2

**MARKING CODE:**  
**96D**